

# SIGNATURE

## NORTH EAST

OFFICIALLY RATED THE NO.1 ESTATE AGENT IN THE NORTH EAST





 Clive Street, North Shields NE29 6HJ

# Clive Street, North Shields NE29 6HJ

**Asking Price**  
**£159,750**

Signature North East welcomes you to this beautiful two-bedroom apartment located in the popular area of North Shields. Recently refurbished to a high standard throughout, this property offers both style and a great location. Perfectly situated just a stone's throw from the stunning coastline, local shops and eateries. Additionally, the North Shields metro station is within easy reach, providing quick access to Newcastle city centre.

Upon entering, you are greeted by a central hallway providing access to all areas of the apartment. The spacious and freshly decorated open plan living/kitchen area is perfect for modern living, offering plenty of room and an abundance of natural light, with a Juliet balcony allowing you to take in the fantastic coastal views. The kitchen is equipped with attractive wall and base units, complemented by sleek countertops. Integrated appliances, including an electric hob and oven, make the space both functional and stylish.

As you continue through the property, you'll discover two generously sized bedrooms. Both rooms can easily accommodate a double bed along with additional furnishings and the master bedroom also benefits from a walk-in wardrobe, offering a dedicated space for dressing. The refurbished shower room, is modern and sleek featuring a spacious shower, hand basin, and W.C.

Externally, the apartment boasts stunning coastal views, offering a peaceful retreat right on your doorstep. The property has gated access to the building for residents and includes one allocated parking space, making it even more convenient. This well-presented apartment truly offers the best of coastal living and modern comfort.



PLEASE NOTE THAT THE VENDOR HAS CERTIFIED THE PROPERTY INFORMATION AND IMAGES.

# PROPERTY FLOORPLAN

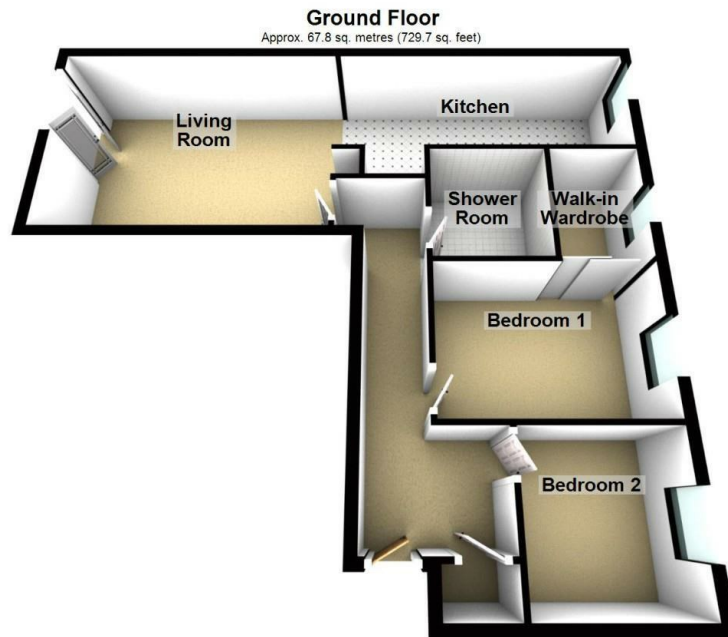

Total area: approx. 67.8 sq. metres (729.7 sq. feet)

Please be advised the floorplans are not drawn to scale and are to be used to give an idea of the layout of the property.  
Plan produced using PlanUp.

## Measurements:

Living Room  
18'4" x 12'1"

Kitchen  
17'7" x 6'10"

Bedroom One  
12'1" x 8'7"

Walk in Wardrobe  
7'0" x 5'1"

Bedroom Two  
8'7" x 8'3"

Shower Room  
7'0" x 6'8"

## Energy Efficiency Rating

	Current	Potential
Very energy efficient - lower running costs		
(92 plus) <b>A</b>		
(81-91) <b>B</b>	<b>83</b>	<b>85</b>
(69-80) <b>C</b>		
(55-68) <b>D</b>		
(39-54) <b>E</b>		
(21-38) <b>F</b>		
(1-20) <b>G</b>		
Not energy efficient - higher running costs		

England & Wales

EU Directive  
2002/91/EC







More 5 Star Customer Reviews than any other Agent based in the North East on allAgents.co.uk



**SALES**

**LETTINGS**

**FINANCE**

**LAW**

**WE COVER THE WHOLE OF THE NORTH EAST**

Whitley Bay  
0191 251 3344

Cramlington  
01670 897 213

Tynemouth  
0191 296 6689

Morpeth  
01670 513 966

Ponteland  
01661 820 082

Wallsend  
0191 432 4151

Alnwick  
01665 511 800

Heaton  
0191 432 4275

Forest Hall  
0191 266 9966

Other locations  
0191 640 3523

Newcastle  
0191 640 2284

Durham  
0191 303 8252

Gosforth  
0191 640 3523

Sunderland  
0191 543 6390

Whickham  
0191 432 5102

Gateshead  
0191 432 4294

Jesmond  
0191 281 1037

Killingworth  
0191 640 3602

Ryton  
0191 413 9845

Head Office &  
Lettings  
0191 253 4815

\*Highest recommended 5-star reviews than any other Estate Agent based in the North East on allAgents.co.uk - The UK's Largest Customer Review Website for the Property Industry & Awarded Best Estate Agency 2018 & 2019 - North East England by SME News